



Hoxton Square, London, N1

BUTLER & STAG



Set on the first floor of this popular modern development on vibrant Hoxton Square is this bright and spacious two bedroom apartment available from 5th June. The property could be available for a 6-month tenancy.



- Two Double Bedrooms
- Two Bathrooms
- Available 7th of July
- Fitted Kitchen
- Great Central Location
- Furnished
- Hoxton Square
- 6-Month Let Considered

Measuring just over 700 sq. ft. this well-proportioned property boasts a wealth of natural light through the floor to ceiling of windows in the open-plan reception. Further comprising a fully fitted modern kitchen, bathroom, two sizeable double bedrooms (master with en-suite) with fitted wardrobes and ample storage space.

Hoxton Square is a sought-after address offering an extensive array of restaurants and fantastic bars. Columbia Road, Brick Lane and Spitalfields Market are all close by and the financial heart of the City is also easily accessible.

Transport links include Old Street (Northern Line and National Rail), Shoreditch Overground and major hub of Liverpool Street (new Crossrail, Central, Metropolitan, Hammersmith & City and Circle lines and National Rail) stations with the City just moments away.

The Landlord will consider a 6-month let for the right tenancy.



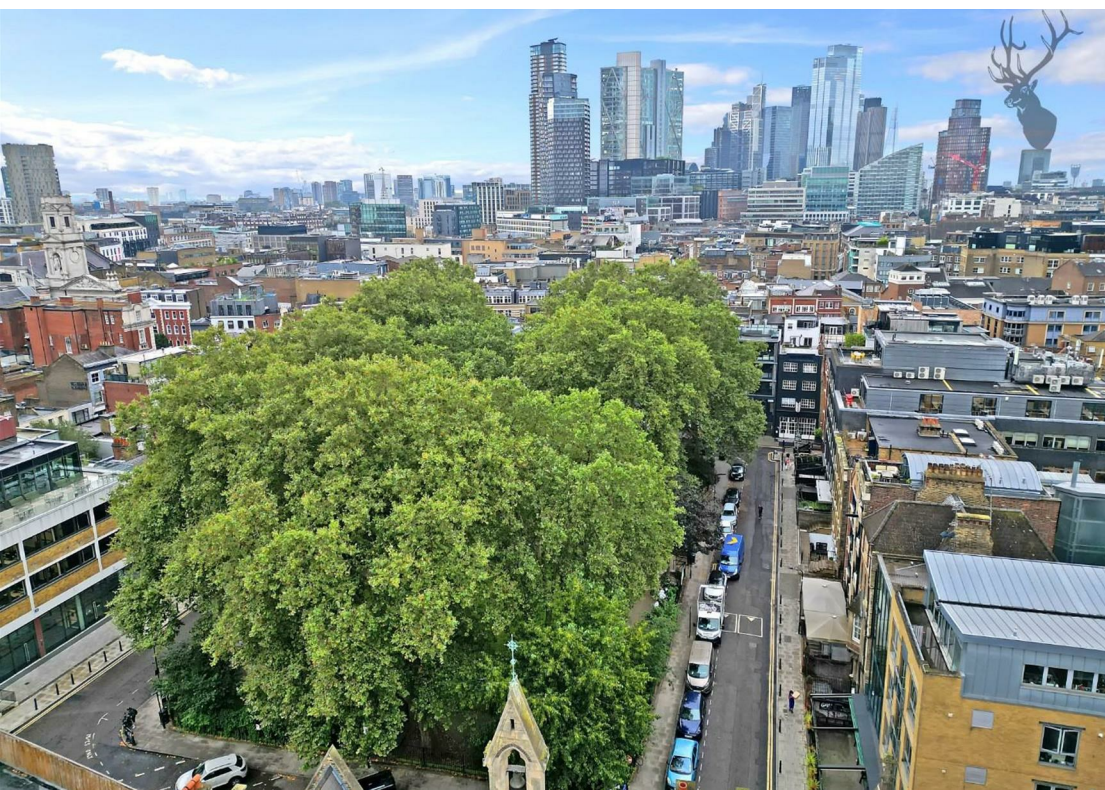

Hoxton Square,

Approx. Gross Internal Area 707 Sq Ft - 65.68 Sq M

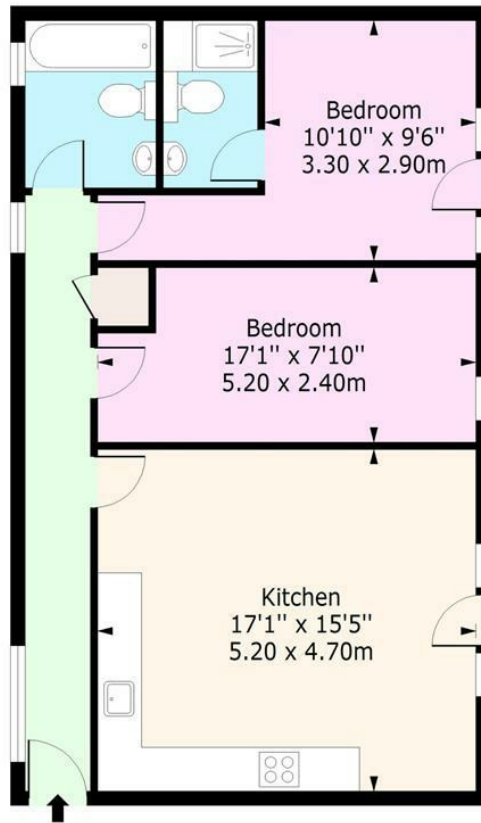

First Floor

Floor Area 707 Sq Ft - 65.68 Sq M

For Illustration Purposes Only - Not To Scale

IMPORTANT NOTICE - These particulars have been prepared in good faith and they are not intended to constitute part of an offer or contract. We have not performed a structural survey on this property and the services, appliances and specific fittings have not been tested. All photographs, measurements, floor plans and distances referred to are given as a guide and should not be relied upon.

BUTLER & STAG

☎ 020 8102 1236

🏠 508 Roman Road, Bow, London, E3 5LU

✉ bow@butlerandstag.com

www.butlerandstag.uk